

## Kurling for Kids 2014

### Electrocautery Equipment for Otolaryngology/ENT

Ear, nose and throat, or ENT, is a term often used to describe the field of otolaryngology, but in recent years, the specialty has become known as otolaryngology-head and neck surgery, a description that more accurately reflects the incredible advances in this area of medicine. The Montreal Children's Hospital has led the way and set new standards of evidence-based medical and surgical care and treatment in a number of ENT sub-specialties. The department handles 13,000 patient visits per year making it one of the busiest in the hospital.



A priority need for ENT is electrocautery equipment, used to destroy tissue using heat conduction from a metal probe heated by electric current. The procedure is used to stop bleeding from small vessels (larger vessels being ligated) or for cutting through soft tissue.

### Ureteroscope for Urology

The team of pediatric urologists at the Children's treats children with common urologic conditions as well as children with complex malformations of the genital and urinary tracts. The types of surgical procedures performed by the urology team are varied and while most children who undergo urological procedures are treated through the hospital's Day Surgery Centre, some require much more complex care.



A ureteroscope is a type of endoscope used to examine the upper urinary tract, by passing it through the urethra, bladder, and then directly into the ureter. The procedure is useful in the diagnosis and the treatment of various kidney and urological disorders.

### Year 3 of the Naming Opportunity at the New Children's Hospital (\$300,000 pledged over 5 years)

"Kurling for Kids" Playroom on the Medical/Surgical Ward - Location: 8<sup>th</sup> Floor, Pavillion B, Size: 14.29 m<sup>2</sup> (154 ft<sup>2</sup>)



The medical/surgical pediatric patient care units will provide high-quality care to general medical and surgical patients who require admission to the hospital. The age group that will be admitted includes those from infant through age 18. This floor will accommodate hospitalized patients, as well as patients admitted to the short stay unit directly from the Emergency Department. All 34 patient rooms will be single, with private washrooms and place for a parent to spend the night. The projected occupancy rate on the wards is about 85%.

As this unit will be running on a 24-hour basis, the child life specialists will have the opportunity to organize a multitude of activities for the patients, including arts & crafts, movie nights and readings, all of which will cater to various age groups. This enclosed, dedicated space will be equipped with toys, books, computer workstations, a sink and adjacent space for storage.

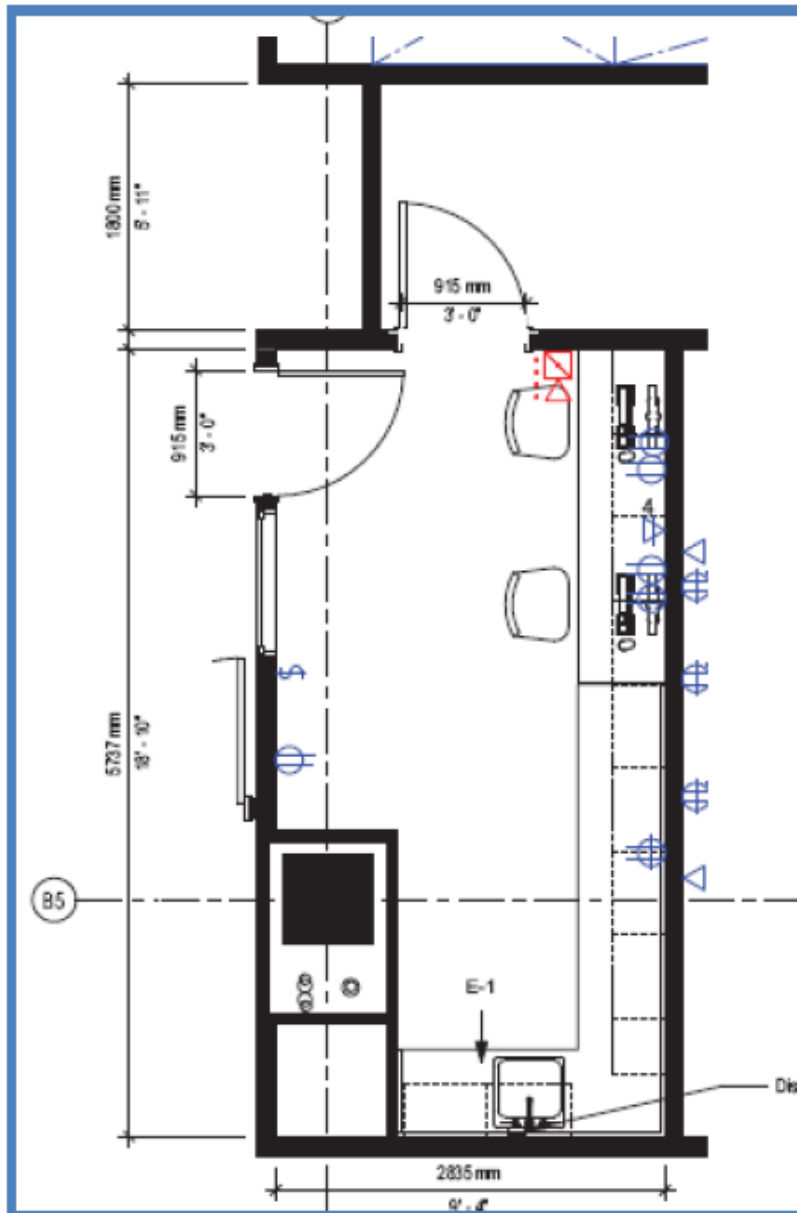

Layout of the Kurling for Kids play room